



Since 1949

Acme Sanitary Ware Co. Ltd.

1/F, Acme Building, 22-28 Nanking Street, Kowloon, Hong Kong

Tel: 2388 7171 Fax: 2710 8012

Email: acme@acmesanitary.com.hk

Website: www.acmesanitary.com.hk

EMCA

PROJECT		REF		REV	ITEM CODE	
LOCATION		DATE			PAGE	

SANITARY WARE SPECIFICATION SHEET

Item Descriptions	EMCA (PRC) 1.2mm stainless steel in grade 316 & satin finish washing trough/ cleaner sink with waste set and front legs	<p>Illustration/ Drawing</p>  <p>(The photo is reference only. Please see the dimensional drawing for confirmation.)</p>
Dimensions	L600 x W500 x H800 mm (Overall) L600 x W500 x H250 mm (Bowl)	
Model	EM0152.703-LG-316	
Material	Stainless Steel Grade 316	
Finish	Satin Finish	
Manufacturer	EMCA (PRC)	
Source	Acme Sanitary Ware Co. Ltd Mr. Eric Wong/ Mr. Don Yuen	
Contact Tel/Fax E-mail Website	(852) 2388-7171 / (852) 2710-8012 acme@acmesanitary.com.hk www.acmesanitary.com.hk	

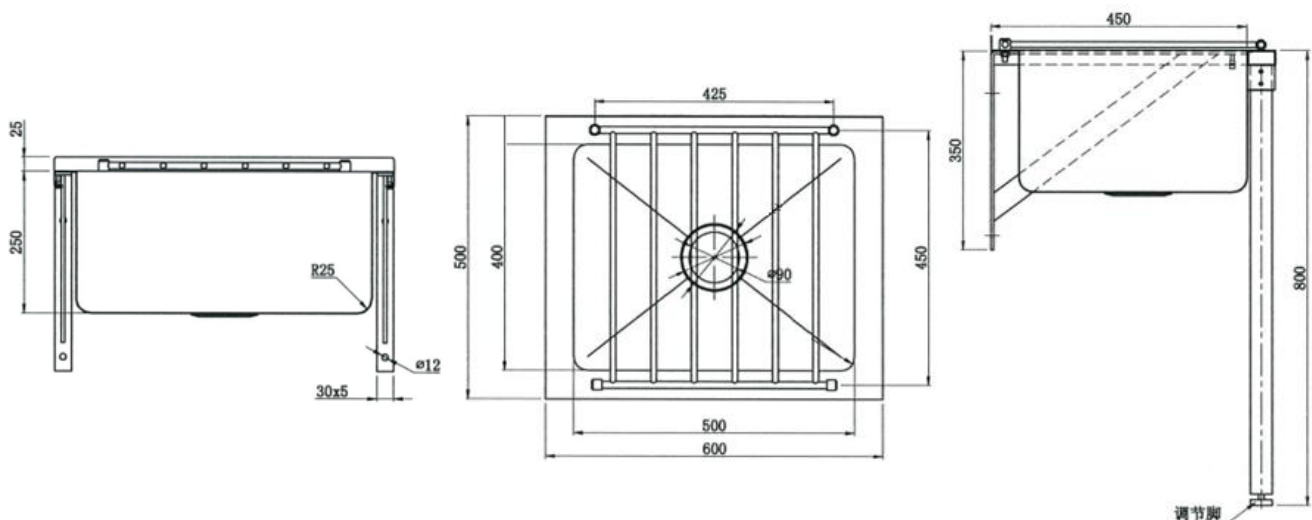

Note: The screws are excluded subject to site environment.

* All information of the above is for the reference only. No prior notice is made if any changes.